

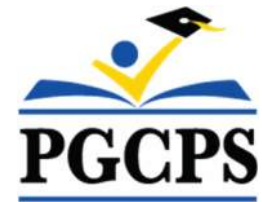

PGCPS . **ENGAGE . DESIGN . BUILD . COMMUNICATE** . PGCPS



BRANDYWINE ACADEMY

PROJECT PLANNING COMMITTEE MEETING #1 | FEBRUARY 19, 2025





Agenda

- Team Introduction
- Transportation Management Plan (Draft)
- Design Updates
- Construction Updates
- Open Discussion
- Contact

Team Introductions



Jeff Barr
PLENARY
Registered Representative

Hafeez Habib
PLENARY
Equity Members' Lead Project Manager

Brett Sullivan
PLENARY
Associate

Adam Dunn
PLENARY
Assistant Project Manager

Jeremy Ebie
PHOENIX
Equity Members' Project Manager

Rob Summers
PHOENIX
Operating Partner

Peter Bullen
ELLISDON CAPITAL
Senior Director



Bill Beschorner
MCN
Construction Process Executive in Charge

Bassem Boustany
MCN
Principal

Yonas Menji
MCN
Lead Construction Manager

Rick Munford
MCN
Preconstruction Director



Sean O'Donnell
PERKINS EASTMAN
Design Process Executive In Charge & Lead Architect

Omar Calderon
PERKINS EASTMAN
Design Principal

Jack Chin
PERKINS EASTMAN
Project Manager



Pete Cambell
ELLISDON FS
Director, P3 Pursuits

Brandon Kelley
USF
Vice President

Johnathan Bolden
RSC
President



Mamo Assefa
Delon Hampton
President

James Gittens
Delon Hampton
Vice President



Connie Fan
LSG
Principal



Jam Kendrick
TB&A
Project Manager

Elevations and Rendering Updates

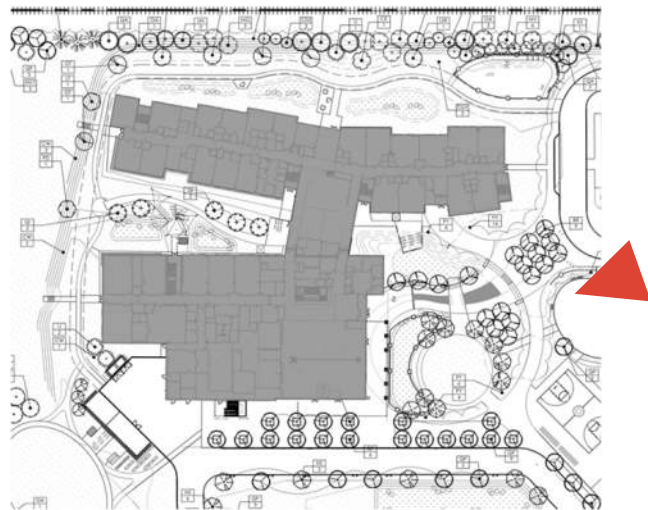

From Playground Looking At Main Entrance

Note: Design is subject to change

Draft TMP Highlights

- Designate a Transportation Coordinator

A high-level school administrator would typically serve in the role of Transportation Coordinator. The Transportation Coordinator acts as a liaison between the school, the community and DPW+T/DPIE to address any operational concerns that arise. The implementation or elimination of TMP strategies would occur under their supervision as would designation of staff to assist in daily tasks associated with the TMP.

Draft TMP Highlights

- Utilize a Crossing Guard at the North Site Access to Dyson Road

The TIS showed that vehicular delay can be high during the peak arrival period at the site driveway. The utilization of a crossing guard or police officer would assist in allowing vehicular traffic to exit the site more efficiently. In addition, safety benefits would be realized as pedestrians crossing the driveway would be aided.

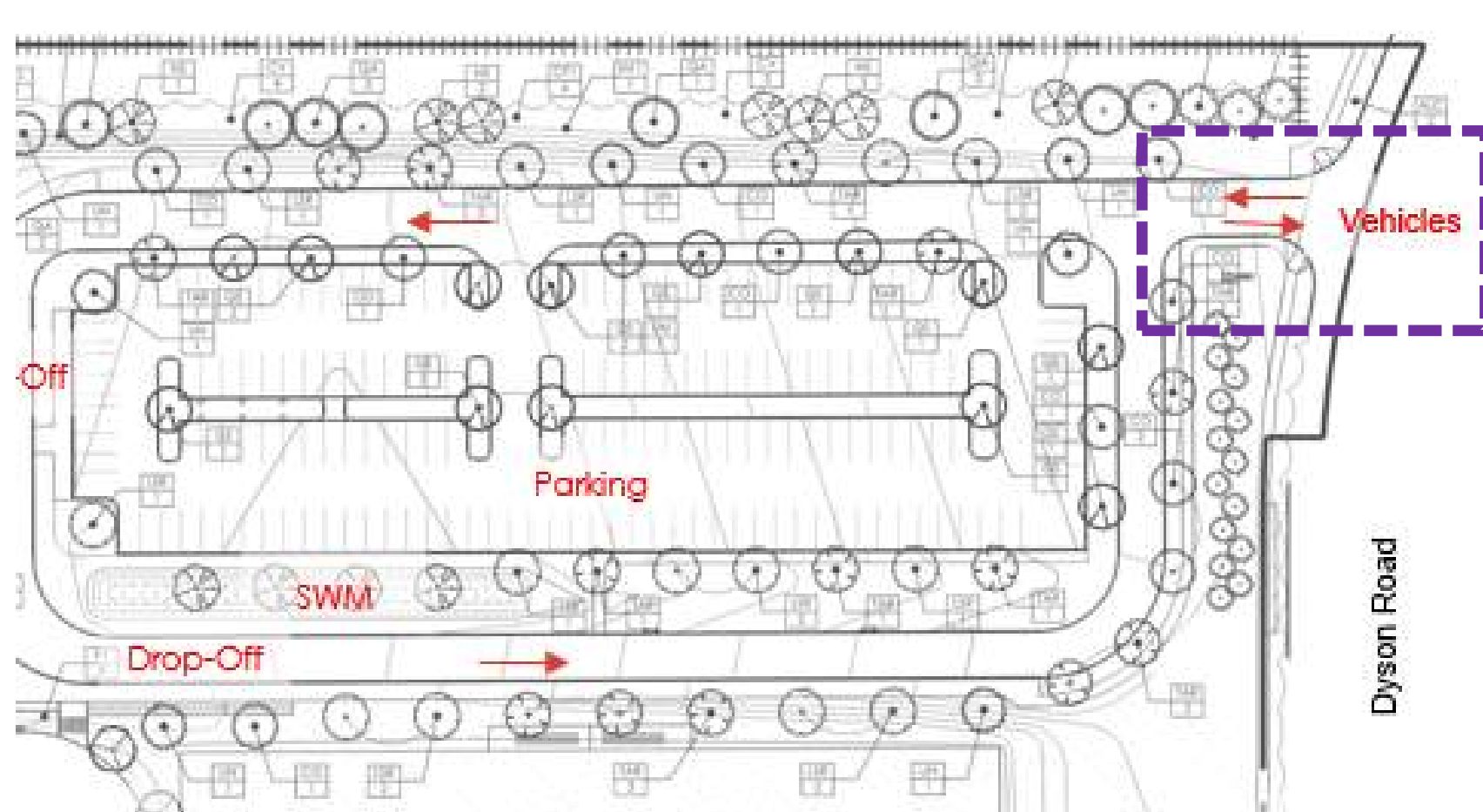

- Assign Staff to Pick Up/Drop-off Locations

Assistance in helping younger children out of personal vehicles in morning can facilitate more efficiency in the drop-off queue. In addition, staff can provide direction to drivers so more than one drop-off can occur simultaneously.

During pick-up in the afternoon, staff could assist in matching students to vehicles which could significantly reduce waiting times.

- Provide Additional Queue Space On-Site

Approximately 42 additional vehicles can queue within the pick-up line if cones are placed within the parking lot to divert traffic flow. This measure would only be necessary if queueing extends beyond the site boundary.

- Parent Education

Instruct parents to not pick up or discharge students within public right-of-way. With additional queuing space provided on site, it is expected that all vehicles can be accommodated on site. Education can occur through email, flyers sent home with students, and/or at PTA Meetings.

- Provide Clear Communication to Stakeholders

In order for safe, efficient operations on-site, it is necessary for stakeholders to understand the strategies that are being implemented. Communication should occur by way of emails, hand-outs to students or other means providing detailed instructions on arrival and dismissal procedures for vehicles and pedestrians, and prohibited actions such as drop-offs off-site.

- Establish Enforcement Parameters

Inevitably, there will be parents that attempt to avoid following the designated procedures and enforcement may need to occur. It likely would be as simple as the Transportation Coordinator reminding drivers of the preferred locations for pick-up and drop-off or alerting them to preferred strategies.

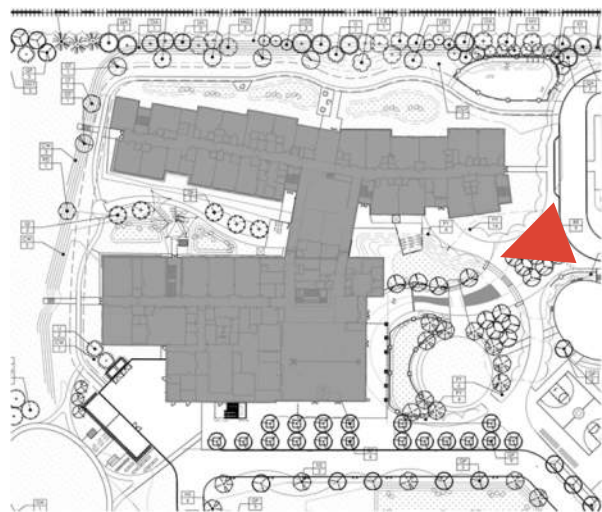

Main Entrance

Note: Design is subject to change

- Early childhood classrooms at grade
- Main entrance
- Heart of the School



Note: Design is subject to change



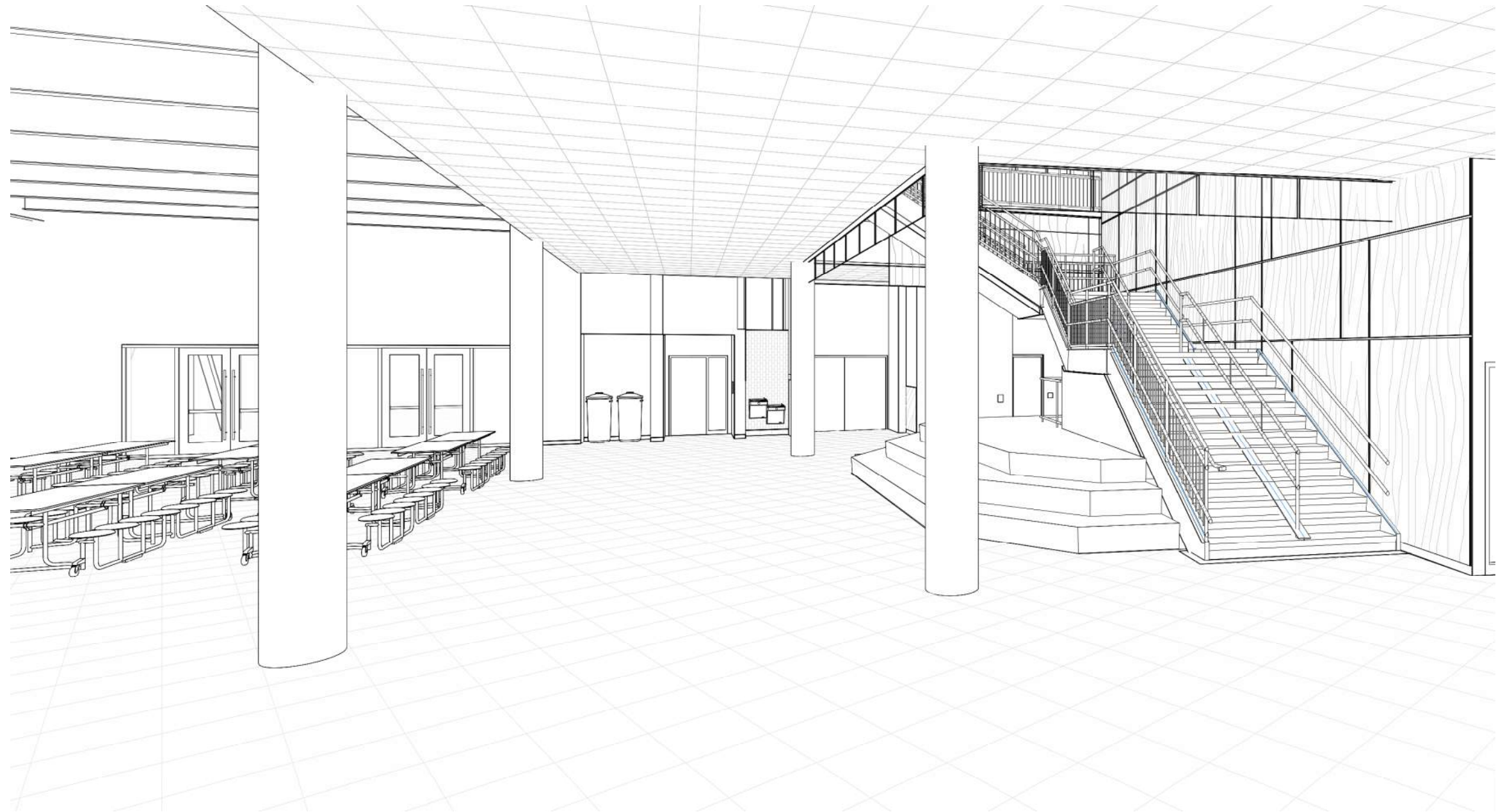

Main Entrance – 1st Floor

Note: Design is subject to change

- Final finishes to be coordinated with school.

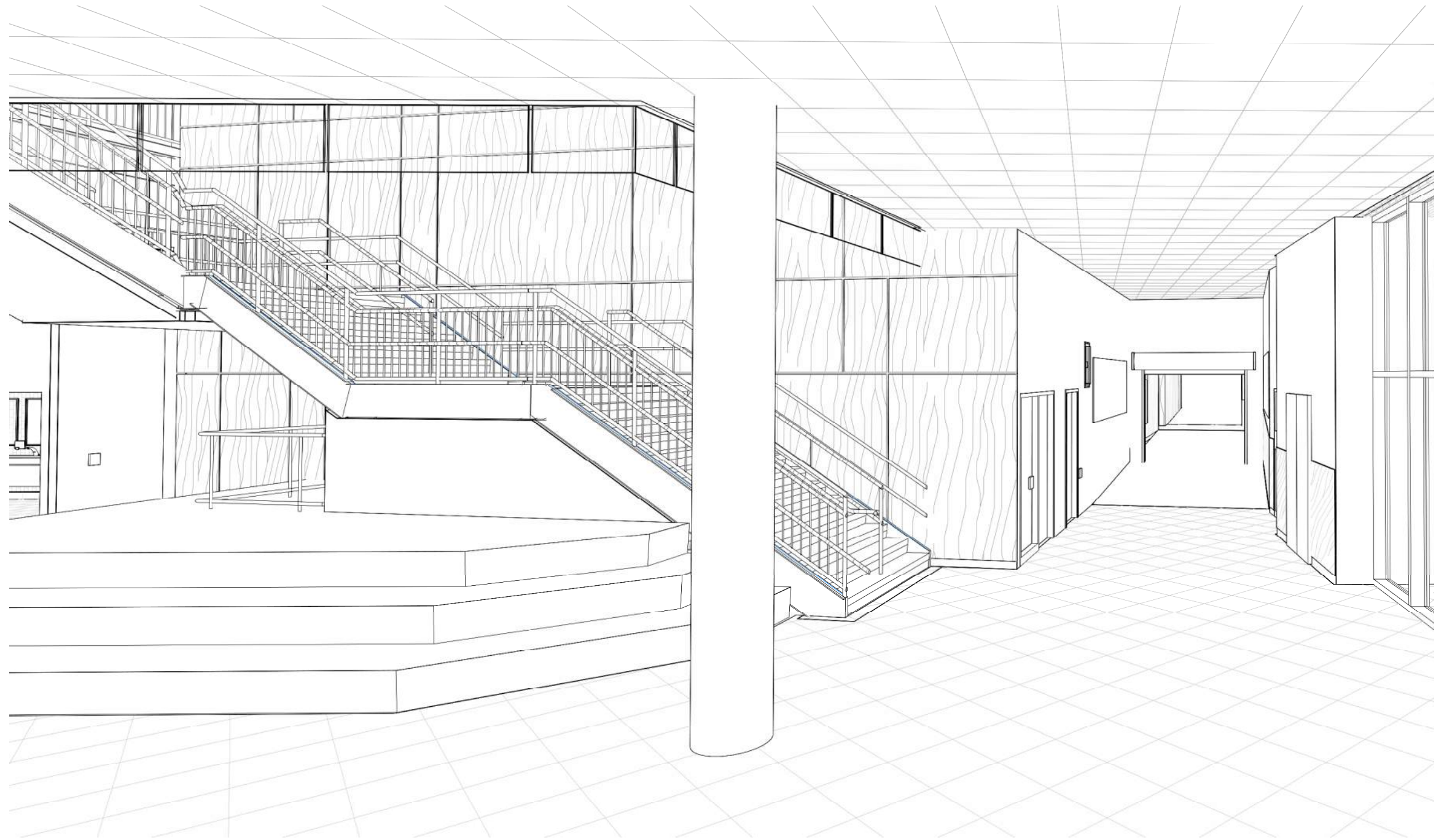

Main Entrance – 1st Floor

Note: Design is subject to change

- Final finishes to be coordinated with school.

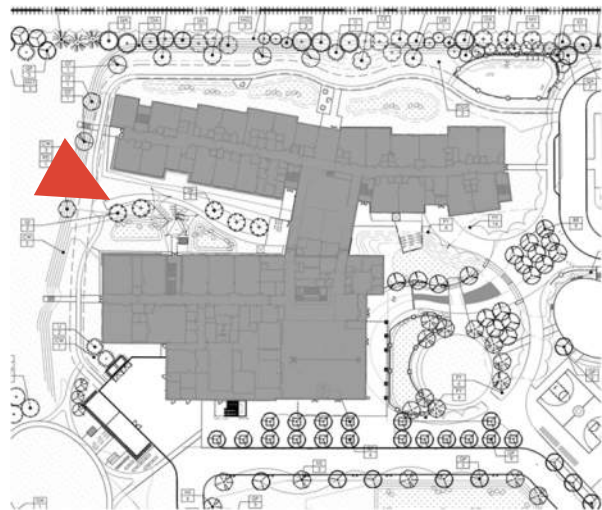

Outdoor Classroom

Note: Design is subject to change

Heart of the School:

- Main Entrance
- Library
- Dining



Note: Design is subject to change



DEPARTMENT LEGEND

- ACADEMIC - CORE
- ACADEMIC - EXTENDED
- ADDITIONAL PROGRAMS
- ADMINISTRATION
- BUILDING SERVICES
- CIRCULATION
- DINING
- LIBRARY
- PERFORMING ARTS
- PHYS ED
- SPECIAL EDUCATION (SEAD)
- SUPPORT

First Level Plan





From Main Corridor Towards Library – 1st Floor

- Final finishes to be coordinated with school.



From Main Corridor Towards Library – 1st Floor

Note: Design is subject to change

- Final finishes to be coordinated with school.

- Elementary and Middle School zones
- Athletics



Note: Design is subject to change



Dining – 1st Floor

Note: Design is subject to change

- Final finishes to be coordinated with school.



View of Bus Drop-off and Dining/Gym Volume

Note: Design is subject to change

Heart of the School:

- Library (below)
- Gym/Stage



DEPARTMENT LEGEND

| | |
|-----------------|--------------------------|
| Blue | ACADEMIC - CORE |
| Light Blue | ACADEMIC - EXTENDED |
| Light Green | ADDITIONAL PROGRAMS |
| Purple | ADMINISTRATION |
| Grey | BUILDING SERVICES |
| Beige | CIRCULATION |
| Orange | DINING |
| Teal | LIBRARY |
| Yellow-Orange | PERFORMING ARTS |
| Light Orange | PHYS ED |
| Light Blue-Gray | SPECIAL EDUCATION (SEAD) |
| Dark Grey | SUPPORT |



Key plan

Note: Design is subject to change



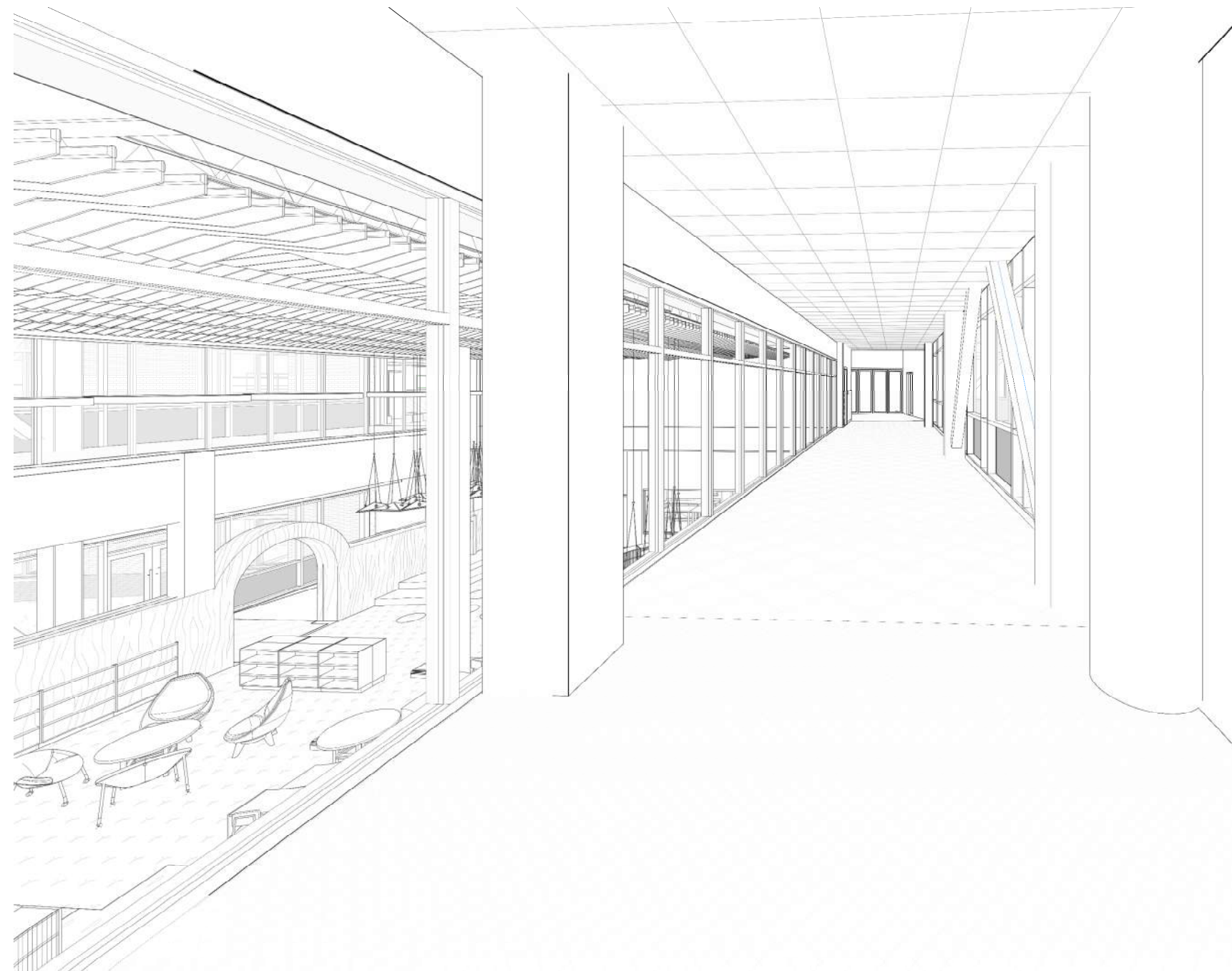

Corridor above library – 2nd Floor

Note: Design is subject to change

- Final finishes to be coordinated with school.

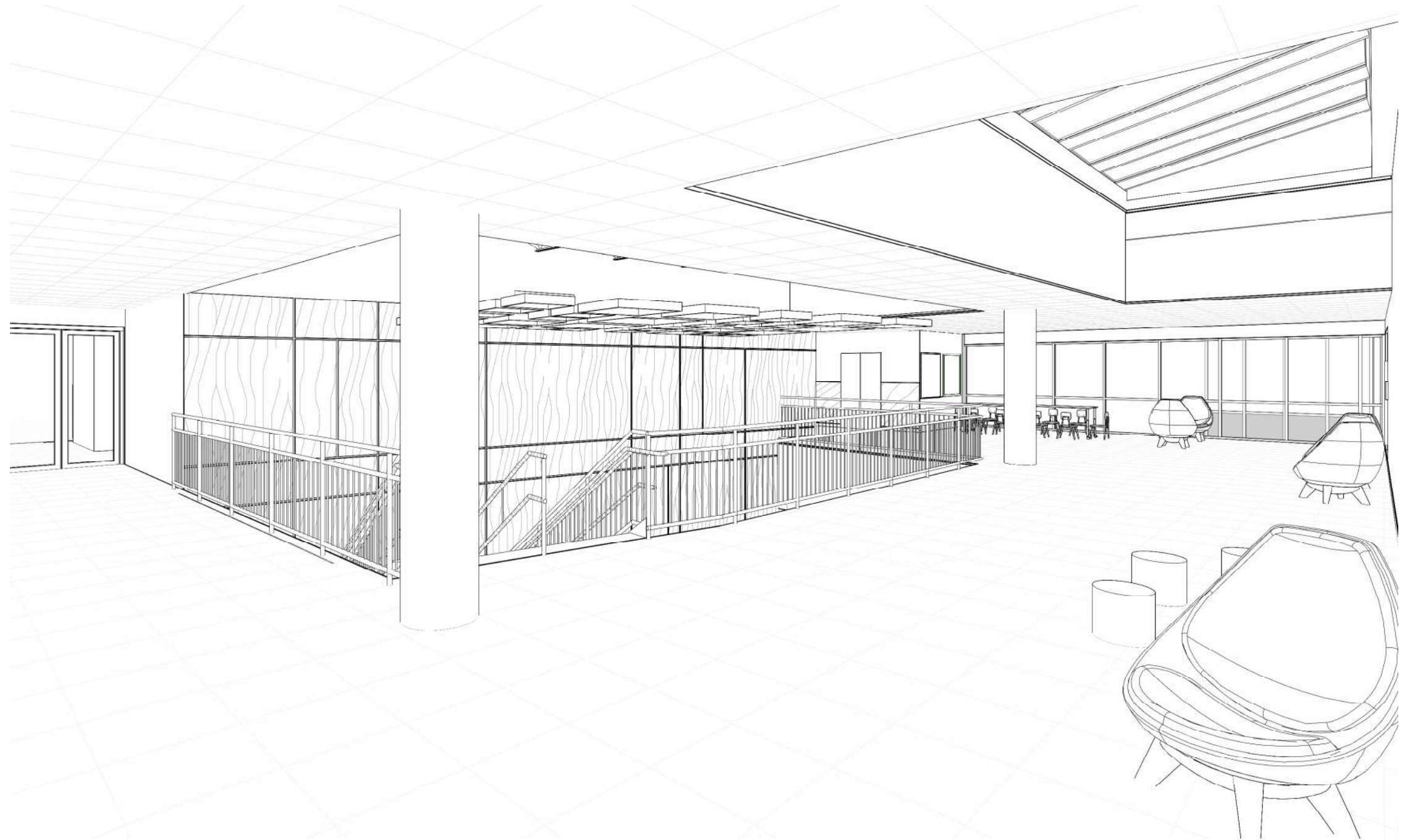

Gymnasium Lobby – 2nd Floor

Note: Design is subject to change

- Final finishes to be coordinated with school.

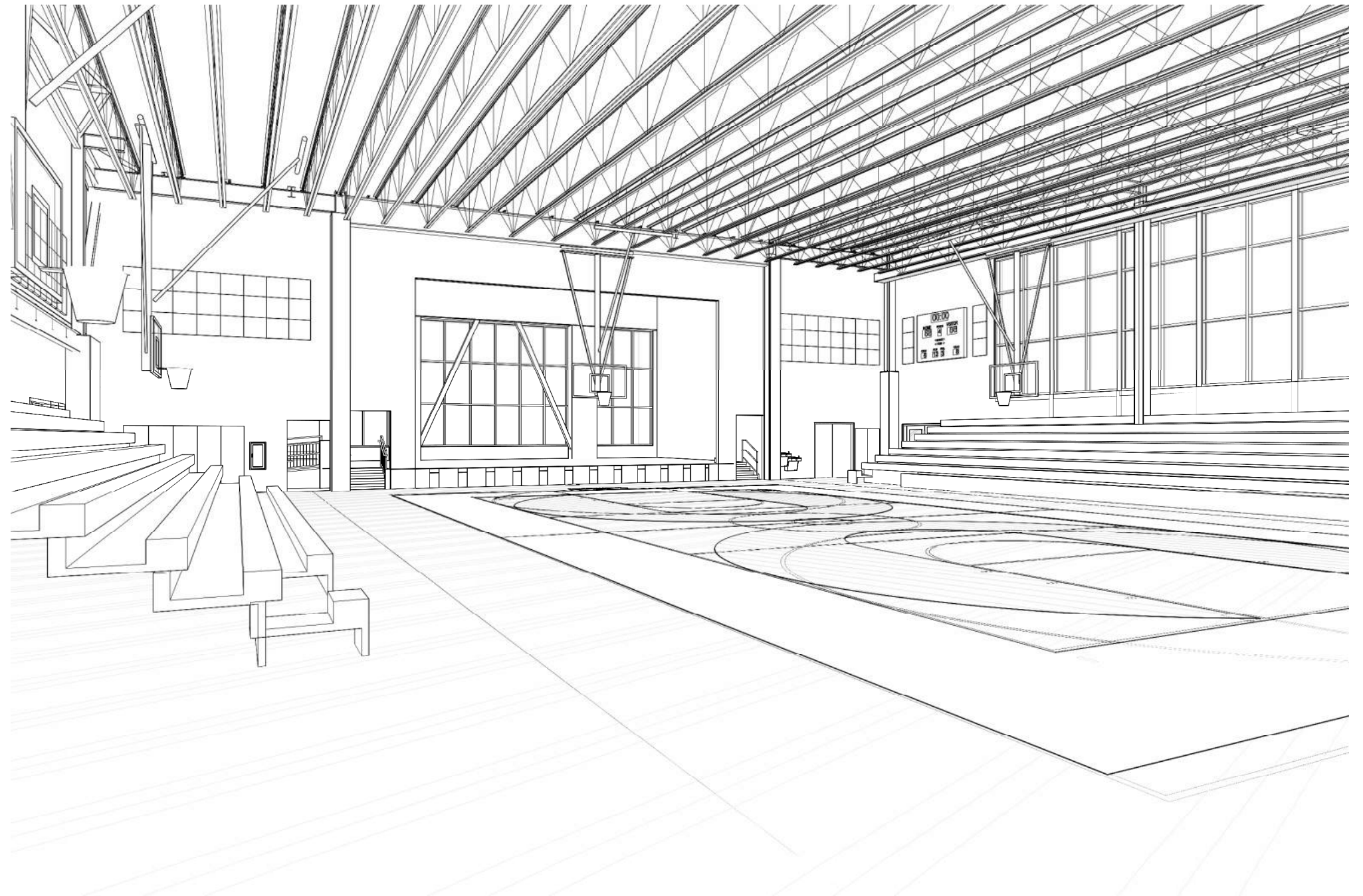

Gymnasium

Note: Design is subject to change

- Final finishes to be coordinated with school.

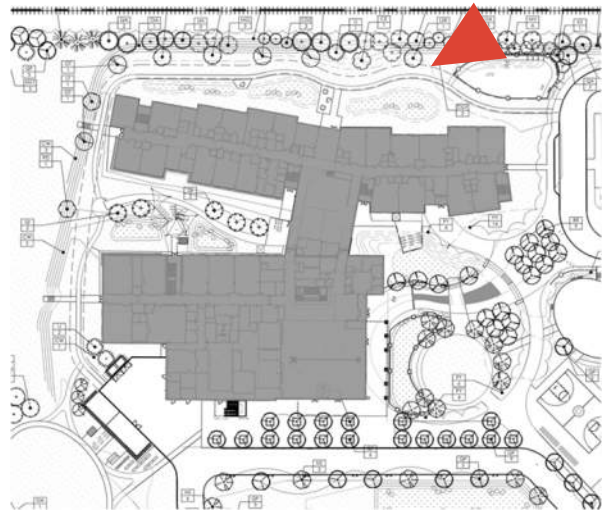

Academic Wing

Note: Design is subject to change

- Upper grade classrooms
- Elementary and Middle School zones



DEPARTMENT LEGEND

| | |
|-------------|--------------------------|
| Blue | ACADEMIC - CORE |
| Light Blue | ACADEMIC - EXTENDED |
| Teal | LIBRARY |
| Orange | PERFORMING ARTS |
| Yellow | PHYS ED |
| Grey | SUPPORT |
| Light Grey | SPECIAL EDUCATION (SEAD) |
| Light Green | ADDITIONAL PROGRAMS |
| Purple | ADMINISTRATION |
| Dark Grey | BUILDING SERVICES |
| Pink | CIRCULATION |



Note: Design is subject to change

Schedule Overview

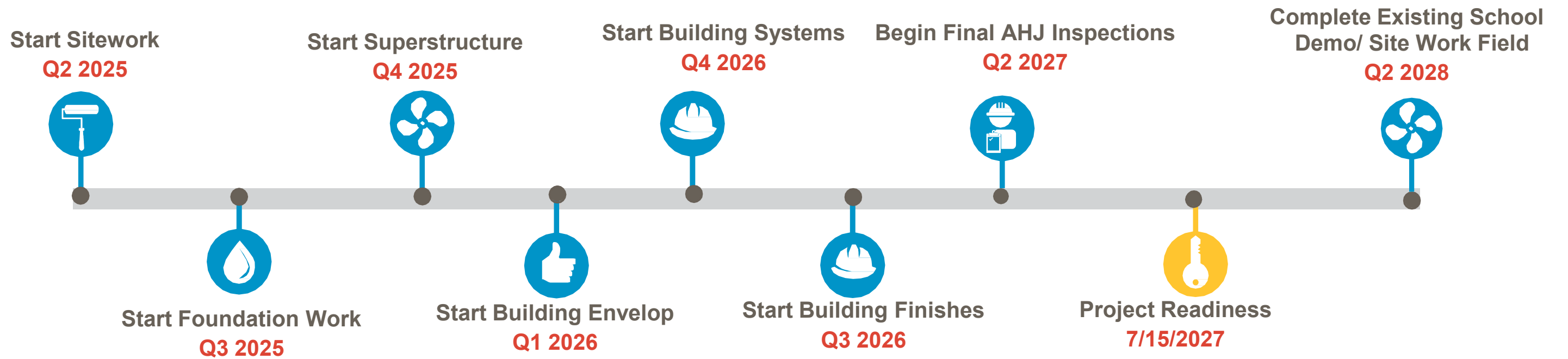

Open Discussion

Next Meetings

For more information, please contact:



Jam Kendrick

pg_jam.kendrick@pgcps.org

pepblueprintschoolsp3.com

